



GRAIN MILL

Instruction Manual



Register this and other Focus Electrics products through our website:
www.focuselectrics.com

Assembling Your Grain Mill	2
Using Your Grain Mill	3
Cleaning Your Grain Mill	3
Helpful Hints.....	3
Warranty	4

SAVE THIS INSTRUCTION MANUAL FOR FUTURE REFERENCE

Congratulations on acquiring your new Grain Mill. The Grain Mill is both a money saving investment and a giant step towards healthier, more flavorful home baking and cooking. You'll enjoy the natural, wholesome goodness and flavor of home ground ingredients prepared fresh and free from all the usual preservatives and additives contained in commercially processed foods. Your Back To Basics® Grain Mill will become a valuable tool in your kitchen and provide years of service.

ASSEMBLING YOUR GRAIN MILL

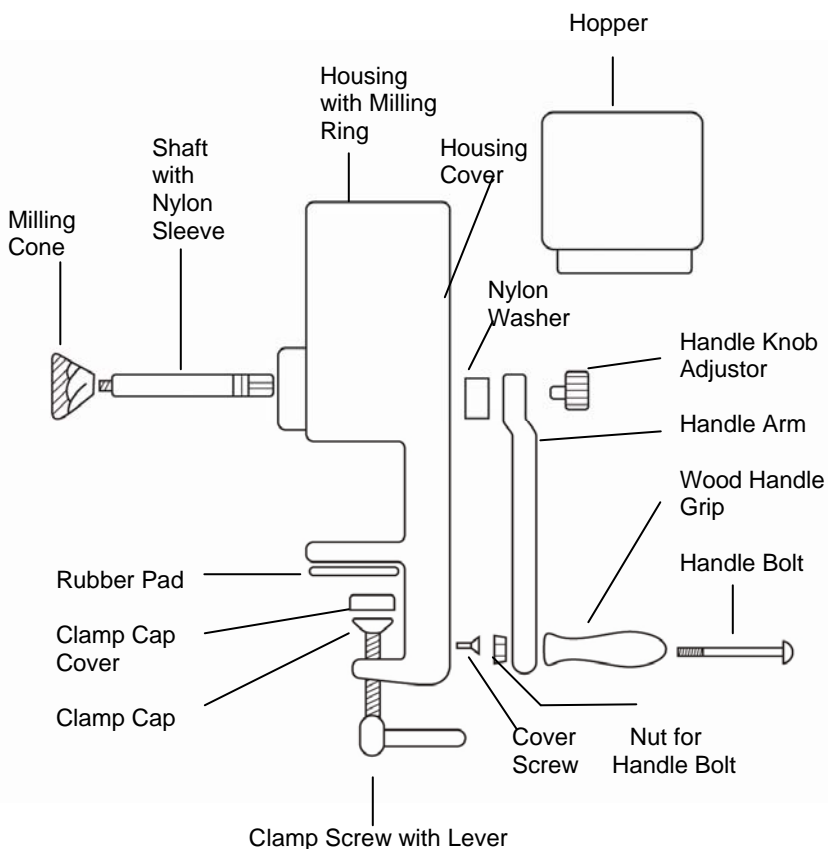

*The handle knob adjustor, handle arm, wood handle grip, handle bolt and nut for the handle bolt is considered the "Arm Assembly." These parts are not sold separately.

Keep your work area, all equipment and utensils clean. Before using, dismantle the grinder and wash all parts in warm, soapy water.

1. Insert the shaft and attached milling cone through the housing.
2. Slip the nylon washer on the end of the shaft.
3. Attach the arm assembly with the handle knob adjustor. **DO NOT OVER TIGHTEN.**

USING YOUR GRAIN MILL

Mount the Grain Mill on a table or counter top and secure with the clamp screw. Select the desired texture by turning the handle knob adjustor clockwise for fine milling or counter-clockwise for a coarser texture. **DO NOT OVER TIGHTEN.** This will cause excessive wear and may damage the grain mill. Turn the handle knob adjustor clockwise until snug, then add grain and begin milling.

CLEANING YOUR GRAIN MILL

The Back To Basics[®] Grain Mill is easy to clean. Simply use a brush or cloth to wipe clean. If a thorough cleaning is needed, wash in warm, soapy water, rinse and dry thoroughly.

HELPFUL HINTS

This product is designed to grind grains and dried nuts. Never put any foreign objects not intended for this product into the grinder.

Most dried beans and nuts can be ground, but may need to be chopped into smaller pieces before the grinder will accept them. This can be done easily with a food chopper or blender.

We do not recommend grinding peanuts or other fresh nuts as they contain too much oil. This will cause the shaft to bind and ruin the milling cone.

PRODUCT WARRANTY

Appliance 2 Year Limited Warranty

Focus Electrics, LLC ("Focus Electrics") warrants this appliance from failures in the material and workmanship for two (2) years from the date of original purchase with proof of purchase, provided the appliance is operated and maintained in conformity with the provided Instruction Manual. Any failed part of the appliance will be repaired or replaced without charge at Focus Electrics' discretion. This warranty applies to indoor household use only.

This warranty does not cover any damage, including discoloration, to any non-stick surface of the appliance. This warranty is null and void, as determined solely by Focus Electrics if the appliance is damaged through accident, misuse, abuse, negligence, scratching, or if the appliance is altered in any way.

THIS WARRANTY IS IN LIEU OF ALL IMPLIED WARRANTIES, INCLUDING WARRANTIES OF MERCHANTABILITY, FITNESS FOR A PARTICULAR PURPOSE, PERFORMANCE, OR OTHERWISE, WHICH ARE HEREBY EXCLUDED. IN NO EVENT SHALL FOCUS ELECTRICS BE LIABLE FOR ANY DAMAGES, WHETHER DIRECT, INDIRECT, INCIDENTAL, FORSEEABLE, CONSEQUENTIAL, OR SPECIAL, ARISING OUT OF OR IN CONNECTION WITH THIS APPLIANCE.

If you think the appliance has failed or requires service within its warranty period, please contact the Focus Electrics Customer Service Department at (866) 290-1851, or e-mail us at service@focuselectrics.com. A receipt proving the original purchase date will be required for all warranty claims, **hand written receipts are not accepted**. You may also be required to return the appliance for inspection and evaluation. Return shipping costs are not refundable. Focus Electrics is not responsible for returns lost in transit.

Valid only in USA and Canada

REPLACEMENT PARTS

Replacement parts, if available, may be ordered directly from Focus Electrics, LLC several ways. Order online at www.focuselectrics.com, e-mail service@focuselectrics.com, over the phone by calling (866)290-1851, or by writing to:

Focus Electrics, LLC
Attn: Customer Service
P. O. Box 2780
West Bend, WI 53095

To order with a check or money order, please first contact Customer Service for an order total. Mail your payment along with a letter stating the model or catalog number of your appliance, which can be found on the bottom or back of the unit, a description of the part or parts you are ordering, and the quantity you would like. Your check should be made payable to Focus Electrics, LLC.

Your state/province's sales tax and a shipping fee will be added to your total charge. Please allow two weeks for processing and delivery.

This manual contains important and helpful information regarding the safe use and care of your new Focus Electrics product. For future reference, attach dated sales receipt for warranty proof of purchase and record the following information:

Date purchased or received as gift: _____

Where purchased and price, if known: _____

Item number and Date Code (shown bottom/back of product): _____